

| Trade | Flux | CCT | Optic | A (mm) |
|---------|------|-------|-------------------------------|--------|
| PSU | 205 | 840 | HNB/HMB/HVBR/HVVR/HOVL/HHOVLV | 158 |
| | 495 | PW930 | NB/MB/WB/VVBR/OVLV | 162 |
| DIA | | | | 251 |
| DIA.VLC | | | All | 253 |
| WA | | | | 224 |

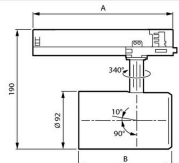

| Flux | CCT | B (mm) |
|------|------------|--------|
| 275 | FMT/Rose/R | 130 |
| 295 | FR/po930 | 149 |
| 495 | | |



Specifications Philips LED Track Spot GreenSpace Evo Projector White 20.5W 2700lm 41x80D - 830 Warm White

[View Product](#)

General Information

| | |
|--------------------------|-----------------------------|
| SKU | 251905 |
| EAN | 8720169590854 |
| manufacturer_code | 8720169590854 |
| Brand | Philips |
| Manufacturer Name | ST333T 27S/830 PSU WB WH481 |
| Any Lamp all-in warranty | 5 Years |
| Average Lifetime (h) | 50000 |

Technical Information

| | |
|-----------------------------|-----------------|
| Technology | LED Integrated |
| Wattage | 20.5W |
| Replaces (Watt) | 35 |
| Voltage (V) | 220-240 |
| Dimmable | Not Dimmable |
| Colour Code | 830 Warm White |
| Colour temperature (Kelvin) | 3000 Warm White |
| Colour Rendering (Ra) | 80-89 |
| Colour of Light | White |
| Light Colour Options | Single Color |
| Luminous Flux (Lumen) | 2700lm |

| | |
|-----------------------|-------------------|
| Lumen per watt | 132 |
| Emergency Lighting | No Emergency Unit |
| Beam Angle (degree) | 41x80 |
| Power factor | >0.90 |
| Product Type Category | LED Trackspot |

Fixture Information

| | |
|------------------------|-------------------|
| Mounting Method | Rail |
| Operating Temperature | 0 to +25 |
| IP-Rating | IP20 |
| Impact Protection (IK) | IK02 - 0.20 joule |
| Housing | Plastic |
| Colour of the Fixture | White |
| Colour of material | White |

Dimensions

| | |
|-------------|-----|
| Length (mm) | 158 |
| Width (mm) | 92 |
| Height (mm) | 190 |

Sensor Information

Type of sensor No Sensor

Why Any-lamp?

 Order from the **largest lighting specialist** in Europe  **Customised** quotation

 Up to **7 years warranty**  **Easy** return process